



## Reversible profile axial impellers up to Ø975 mm

### > Product features

**HasconWing® R impellers** are manufactured assembling reversible profile blades made of aluminum, with a light aluminum alloy hub. The impellers are thought to be employed in applications with high temperatures (i.e. drying rooms). The impellers are available in configurations with 5/9/12/16 blades both for clockwise and anti-clockwise rotation. Blades are available with setting angles ranging from 20° to 45° and producing a reversible air flow.



### > Applications

- BRICK DRYING
- LEATHER DRYING
- TIMBER DRYING
- HEAT EXCHANGERS
- COOLING TOWERS
- VENTILATORS FOR LIVESTOCK
- INDUSTRIAL VENTILATORS
- HIGH TEMPERATURES

### > Highlights

-  free fan selection software is available for download at [www.hwventilation.it](http://www.hwventilation.it)
-  our fans are tested in **AMCA 210/07** wind tunnel and comply with EU Directive 2015
- **RESISTANT** to temperatures up to 250°C

## > Specifications

**HasconWing® R impellers** are configurable with 5/9/12/16 reversible blades. Blades are available with setting angles ranging from 20° to 45°.

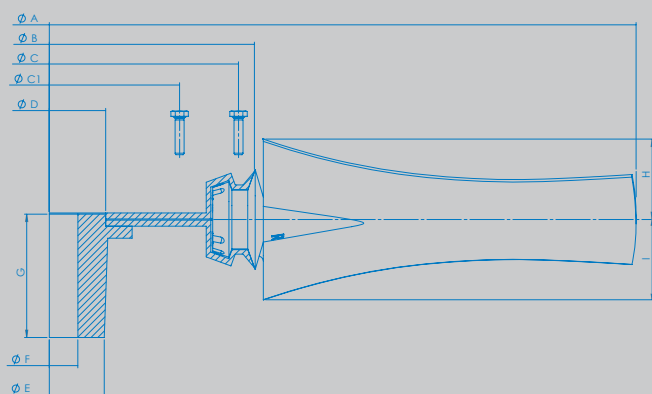

	R
A= chords	145
B= length	300
Max ø impellers	975

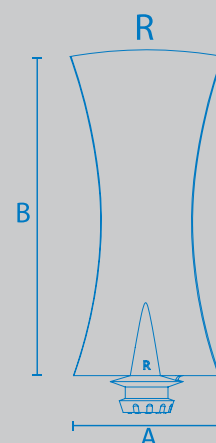

BLADE n°	BLADE Type	max ø A mm	ø B mm	ø C mm	n° holes ø C mm	ø C1*** mm	n° holes ø C1	ø D mm	ø E mm	ø F mm	G mm
5	R	750	158	139	5 Ø 6,5	-	-	55	44 - 52	14 ÷ 34	42-62
9*	R	800	202	184	9 Ø 6,5	110	9 Ø 6,5	75 - 95	45 - 51 73 - 95	14 ÷ 42	0-42-52 62-82-112
12*	R	880	280	264	12 Ø 6,5	185	12 Ø 6,5	75 - 170	45 - 51 73 - 95	14 ÷ 42	0-42-52 62-82-112
16**	R	975	375	358	16 Ø 6,5	280	16 Ø 6,5	75 - 240	45 - 51 73 - 95	14 ÷ 55	0-42-52 62-82-112

\* nr 5 Ø 6,5 holes on Ø 90 for interchangeable boss connections

\*\* nr 5 Ø 6,5 holes on Ø 90 and nr 9 Ø 6,5 holes on Ø 110 for interchangeable boss connections

\*\*\* only for medium or total tightening

Blade Type		25°	27.5°	30°	32.5°	35°	37.5°	40°	45°
R	I	34	38	40	44	47	49	52	54
	H	34	38	40	44	47	49	52	54

Tolerance ± 2mm

## > Materials

**HasconWing® R blades** are available in aluminum to suit a variety of applications which are characterized by high temperatures.

MATERIAL	DESCRIPTION	STD. COLOR	OP. TEMPERATURE*
ALU	Aluminum	-	-80°C to +250°C

\*Contact technical dpt. for customized advise